

6 MAINTENANCE AND CLEANING

The following points have to be considered during the inspection:

- 1 All screws for installing the devices or parts of the device have to be tightly connected and must not be corroded.
- 2 There must not be any deformations on the housing, color lenses, fixations and installation spots (ceiling, suspension, trussing).
- 3 Mechanically moved parts must not show any traces of wearing and must not rotate with unbalances.
- 4 The electric power supply cables must not show any damage, material fatigue or sediments.

Further instructions depending on the installation spot and usage have to be adhered by a skilled installer and any safety problems have to be removed.



CAUTION

Disconnect from mains before starting maintenance operation.



In order to make the lights in good condition and extend the life time, we suggest a regular cleaning to the lights.

- 1 Clean the inside and outside lens each week to avoid the weakness of the lights due to accumulation of dust.
- 2 Clean the fan each week.
- 3 A detailed electric check by approved electrical engineer each three month, make sure that the circuit contacts are in good condition, prevent the poor contact of circuit from overheating.

We recommend a frequent cleaning of the device. Please use a moist, lint- free cloth. Never use alcohol or solvents.

There are no serviceable parts inside the device. Please refer to the instructions under (Installation instructions).

Should you need any spare parts, please order genuine parts from your local dealer.

MOXLITE



Contact

@moxlite.prolight
+62 859 2122 1107
info@moxlite.com

HQ & Workshop

Global Multipro Technology
Rukan Crown B no. 25
Greenlake City, Cipondoh, Tangerang

MOXLITE

MAXINE



User Manual

KEEP THIS MANUAL FOR FUTURE NEEDS

www.moxlite.com

1 SAFETY INSTRUCTIONS



CAUTION

Becareful with your operations. With a dangerous voltage you can suffer a dangerous electric shock when touching wires!

This device has left the factory in perfect condition. In order to maintain this condition and to ensure a safe operation, it is absolutely necessary for the user to follow the safety instructions and warning notes written in this user manual.



IMPORTANT

Damages caused by the disregard of this user manual are not subject to warranty. The dealer will not accept liability for any resulting defects or problems.

If the device has been exposed to temperature changes due to environmental changes, do not switch it on immediately. The arising condensation could damage the device. Leave the device switched off until it has reached room temperature.

This device falls under protection-class I. Therefore it is essential that the device be earthed.

The electric connection must carry out by qualified person.

The device shall only be used with rated voltage and frequency.

Make sure that the available voltage is not higher than stated at the end of this manual.

Make sure the power cord is never crimped or damaged by sharp edges. If this would be the case, replacement of the cable must be done by an authorized dealer.

Always disconnect from the mains, when the device is not in use or before cleaning it. Only handle the power cord by the plug. Never pull out the plug by tugging the power cord.

During initial start-up some smoke or smell may arise. This is a normal process and does not necessarily mean that the device is defective, it should decrease gradually.

Please don't project the beam onto combustible substances.

Fixtures cannot be installed on combustible substances, keep more than 50cm distance with wall for smooth air flow, so there should be no shelter for fans and ventilation for heat radiation.

If the external flexible cable or cord of this luminaire is damaged, it shall be exclusively replaced by the manufacturer or his service agent or a similar qualified person in order to avoid a hazard.

5 DMX CHANNELS

CH04Channel Table Description:

passageway	Channel value	Basic functions of channel
1	000-255	R Red lamp bead linear dimming
2	000-255	G Green bead linear dimming
3	000-255	B Blue lamp bead linear dimming
4	000-255	W White lamp bead linear dimming

CH12Channel Table Description:

passageway	Channel value	Basic functions of channel
1	000-255	General dimming
2	000-255	Stroboscopic
3	000-255	R Red lamp bead linear dimming
4	000-255	G Green bead linear dimming
5	000-255	B Blue lamp bead linear dimming
6	000-255	W White lamp bead linear dimming
7	000-255	Macro Color
8	000-255	pattern
9	000-255	speed
10	000-255	direction
11	000-255	Background color
12	000-255	Background tone light

CH144Channel Table Description:

passageway	Channel value	Basic functions of channel
1	000-255	Linear dimming of the first red lamp bead
2	000-255	Linear dimming of the first green lamp bead
3	000-255	Linear dimming of the first blue lamp bead
4	000-255	Linear dimming of the first white lamp bead
...
141	000-255	36th red lamp bead linear dimming
142	000-255	36th green lamp bead linear dimming
143	000-255	36th blue lamp bead linear dimming
144	000-255	36th white lamp bead linear dimming

A001	➡	A512	Modify the address code (A001~A512) upward or downward, and press OK to save. The default is A001.
C004	➡	C144	Modify channels C004, C12 and C144 up or down, and press OK to save. The default is CH12.
M000	➡	M096	Modify the built-in effect (M000~M096) up or down, and press OK to save. The default is M000.
S000	➡	S255	Modify the running speed of the built-in effect (S000~S255) up or down, and press OK to save. The default is S010.
R255	➡	R000	Modify the brightness of the red lamp bead (R000~R255) up or down, and press OK to save. The default value is R255.
G255	➡	G000	Modify the green lamp bead brightness (G000~G255) upward or downward, and press OK to save. The default is G255.
B255	➡	B000	Modify the blue light bead brightness (B000~B255) up or down, and press OK to save. The default is B255.
W255	➡	W000	Modify the white lamp bead brightness (B000~B255) upward or downward, and press OK to save. The default is B255.
T000			Display temperature, for example, T045 indicates that the current lamp temperature is 45 °C; The 10K thermistor display T000 is not installed.

Factory Settings

When any address code is A001~A512, press the menu key for 5 seconds to enter the factory setting. Factory setting mainly includes the functions of lamp output power, fan setting mode, setting temperature protection point and sending parameters. Press the menu key for 5 seconds to exit any mode set in the factory.

Factory Setting Table:

R255	➡	R032	Modify the red lamp bead current (R032~R255) up or down, and press OK to save. The default is R220.
G255	➡	G032	Modify the green lamp bead current (G032~G255) upward or downward, and press OK to save. The default is G220.
B255	➡	B032	Modify the blue lamp bead current (B032~B255) up or down, and press OK to save. The default is B220.
W255	➡	W032	Modify the white lamp bead current (w032~w255) upward or downward, and press OK to save. The default value is w220.
Dir0	➡	Dir7	Modify the flow direction (d0~d7) upward or downward, and press OK to save. The default is d0.
FAN0	➡	FAN1	Fan setting: start the fan when the FAN0 light is on, start the fan when the FAN1 temperature reaches 40 °C, and press the OK key to save.
T040	➡	T070	Set the temperature protection point, modify the parameters up or down (40 °C~70 °C), press the OK key to save, and the default is T065.
Send	➡	Send	Send the factory setting parameters of the machine up or down to the lamps connected in parallel with all other three core signal lines; To confirm the sending parameters, press the menu key for 5 seconds to exit, and to deny the parameters, press the OK key to cancel the sending.

2 UNPACKING

Maxine, state-of-the-art matrix panel producing attractive narrow beam effect. The fixture features 36*15W 4-in-1 RGBW LEDs integrated in high efficiency 2°optic lens nicely assembled in the die-cast aluminum housing. Each LED are controllable individually for pixel mapping. It's available for stand alone mode with internal signs and patterns with running effects with speed and step control, DMX control or Sound control. The PIXELPANEL is designed with professional and safe locking system to combine numbers of panels together for professional programming. This helps to build an ultra eye catching back-ground wall for vivid colorful lighting effect, strong beam effect and various strobe effect.

Maxine is ideal for bars/clubs/dancing halls and other entertainment venues.

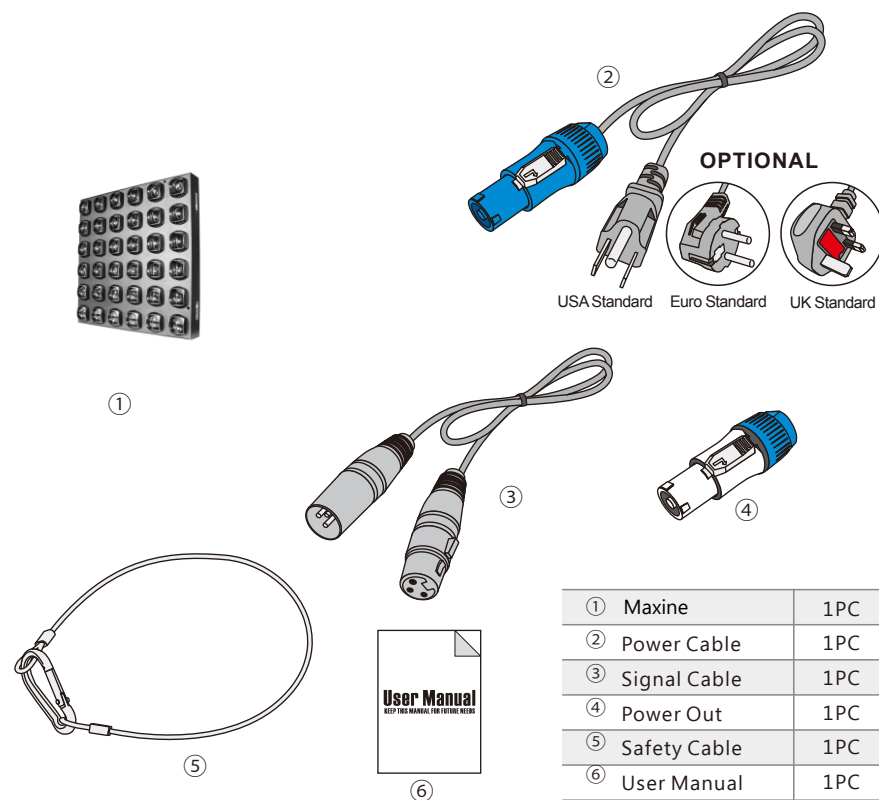

①	Maxine	1PC
②	Power Cable	1PC
③	Signal Cable	1PC
④	Power Out	1PC
⑤	Safety Cable	1PC
⑥	User Manual	1PC

3 FEATURES & SPECIFICATIONS

Features

36*15W 4-IN-1 LEDs, RGBW
Each LED controllable individually for pixel mapping
Flicker free operation for broadcast TV and FILM
Life Span: 50000H
High efficiency square optic system
2°Beam angle
High output
RGBW
Identical narrow colorful beam effect
Different internal patterns with speed and step controllable
0-25Hz LED shutter/strobe effect with variable speed
0-100% Smooth linear LED dimming
4/12/144 DMX channels USITT DMX-512
RDM, DMX512, master-slave, sound or auto operation
Shielded input signal protection for stable signal without interference
3-pin XLR connectors IN/OUT
4-Digit LED display
4 Control buttons
Display auto OFF
Electronic supply with active PFC
AC100-240V 50/60Hz
Powercon connectors IN/ OUT
500W Power consumption
-25°C to 45°C ambient temperature
IP20 protection rating
N.W.: 9.6kg
G.W.: 11.6kg
Product Dimensions: 188.3(D)*500(W)*500(H)mm
Packing Dimensions: 250(D)*530(W)*530(H)mm

4 MENU OPERATIONS



MENU UP DOWN ENTER

Key definition:

Menu key: Select function

Up key: parameter addition

Down key: decrease the parameter

Confirm key: confirm and save

Menu functions

After power on, press the menu key to display the menu menu in turn; The up or down key is used to modify the function parameters, and the confirmation key is used to save the current functions and parameters (power down memory is available after saving).

Menu Menu: