

IP HOLYSTORM HYBRID



Contact

@moxlite.prolight
+62 859 2122 1107
info@moxlite.com

HQ & Workshop

Global Multipro Technology
Rukan Crown B no. 25
Greenlake City, Cipondoh, Tangerang

User Manual

KEEP THIS MANUAL FOR FUTURE NEEDS

www.moxlite.com

1 SAFETY INSTRUCTIONS



CAUTION

Becareful with your operations. With a dangerous voltage you can suffer a dangerous electric shock when touching wires!

This device has left the factory in perfect condition. In order to maintain this condition and to ensure a safe operation, it is absolutely necessary for the user to follow the safety instructions and warning notes written in this user manual.



IMPORTANT

Damages caused by the disregard of this user manual are not subject to warranty. The dealer will not accept liability for any resulting defects or problems.

If the device has been exposed to temperature changes due to environmental changes, do not switch it on immediately. The arising condensation could damage the device. Leave the device switched off until it has reached room temperature.

This device falls under protection-class I. Therefore it is essential that the device be earthed.

The electric connection must carry out by qualified person.

The device shall only be used with rated voltage and frequency.

Make sure that the available voltage is not higher than stated at the end of this manual.

Make sure the power cord is never crimped or damaged by sharp edges. If this would be the case, replacement of the cable must be done by an authorized dealer.

Always disconnect from the mains, when the device is not in use or before cleaning it. Only handle the power cord by the plug. Never pull out the plug by tugging the power cord.

During initial start-up some smoke or smell may arise. This is a normal process and does not necessarily mean that the device is defective, it should decrease gradually.

Please don't project the beam onto combustible substances.

Fixtures cannot be installed on combustible substances, keep more than 50cm distance with wall for smooth air flow, so there should be no shelter for fans and ventilation for heat radiation.

If the external flexible cable or cord of this luminaire is damaged, it shall be exclusively replaced by the manufacturer or his service agent or a similar qualified person in order to avoid a hazard.

6 MAINTENANCE AND CLEANING

The following points have to be considered during the inspection:

- 1) All screws for installing the devices or parts of the device have to be tightly connected and must not be corroded.
- 2) There must not be any deformations on the housing, color lenses, fixations and installation spots (ceiling, suspension, trussing).
- 3) Mechanically moved parts must not show any traces of wearing and must not rotate with unbalances.
- 4) The electric power supply cables must not show any damage, material fatigue or sediments.

Further instructions depending on the installation spot and usage have to be adhered by a skilled installer and any safety problems have to be removed.



CAUTION

Disconnect from mains before starting maintenance operation.



In order to make the lights in good condition and extend the life time, we suggest a regular cleaning to the lights.

- 1) Clean the inside and outside lens each week to avoid the weakness of the lights due to accumulation of dust.
- 2) Clean the fan each week.
- 3) A detailed electric check by approved electrical engineer each three month, make sure that the circuit contacts are in good condition, prevent the poor contact of circuit from overheating.

We recommend a frequent cleaning of the device. Please use a moist, lint-free cloth. Never use alcohol or solvents.

There are no serviceable parts inside the device. Please refer to the instructions under "Installation instructions".

Should you need any spare parts, please order genuine parts from your local dealer.

2 UNPACKING

The IP Holystorm Hybrid is an ultra high power IP65 rated strobe light basing on LED technology. It features an LED tube (main strobe) with 3535 LEDs 144*5W Cool-White 6500K in 4 segments, plus 5050 LEDs (auxiliary panel light) 576*0.5W RGB 3in1 in 8 (2*4) segments. All these segments, either the main strobe or the auxiliary panel light, can be individually controllable for various color changing effects, strobe effects, and macro effects, to meet with diversified entertainment functions.

The fixture brings high brightness, wide-angle light strobe, and perfect light distribution. Esp. with 185° tilt movement and high speed and strong shutter/strobe effects, it offers the users more dynamic effects than conventional discharge strobe systems.

The molded housing is designed compact and stylish. Rated IP65, it's applicable for most outdoor applications, music festivals, live concerts, road shows, etc.

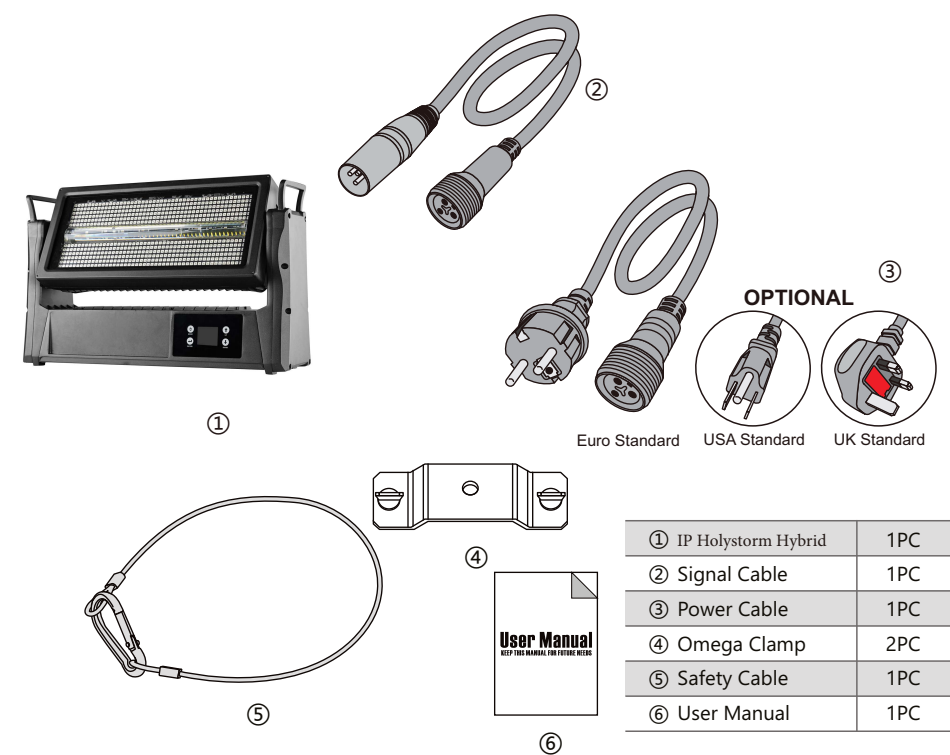

3 FEATURES & SPECIFICATIONS

3535 LEDs 144*5W Cool-White 6500K, 4 segments

Auxiliary Strobe Panel

5050 LEDs 576*0.5W RGB 3in1, 8 (2 x 4) segments Life

Span: 50000H

High resolution and precise optic system

120°Projection angle

Built-in pre-programmed effects

0-20Hz shutter/strobe effects at variable speed

Tilt 255° (8/16-bit)

8/14/18/61 DMX channels USITT DMX-512

RDM available (Remote Device Management)

DMX512, master-slave, sound or auto operation

Seetronic powerCON TRUE1 Power In/Out

Seetronic IP65 3-Pin/5-Pin XLR DMX connectors IN/OUT

Wireless Optional: 2.4 GHz W-DMX™

AC100-240V 50/60Hz

1000W Power consumption

-25°C to 45°C ambient temperature

IP65 protection rating

N.W.: 10kg

G.W.: 12.5kg

Product Dimensions: 178(D)*482(W)*243(H)mm

Packing Dimensions: 230(D)*640(W)*360(H)mm

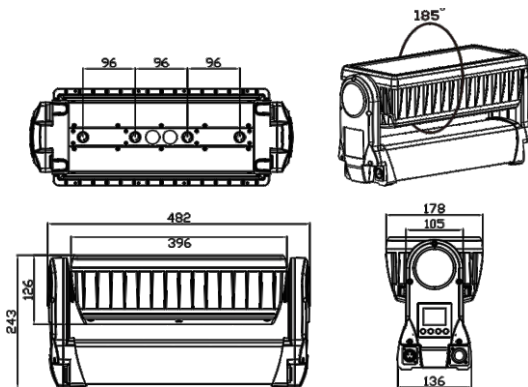

61-channel mode

Passage way	Function	Explain
CH1.	.Y axis	Y axis rotates
CH2.	Y-axis speed	Speed from fast to slow
CH3.	Total dimming	R, G, B,W.Total dimming, from dark to bright
CH4.	Total strobe	R, G, B,W.Total strobe, from slow to fast
CH5.	White light 1	White light 1Dimming, from dark to bright.
CH6.	White light 2	White light 2Dimming, from dark to bright.
...
CH12.	White light 8	White light 8Dimming, from dark to bright.
.CH13.	Red light 1	Red light 1, from dark to bright.
CH14.	Green light 1	Green light 1, from dark to bright.
CH15.	Blu-ray 1	Blu-ray 1, from dark to bright.
...
CH58.	Red light 16	Red light 16, from dark to bright.
CH59.	Green light 16	Green light 16, from dark to bright.
CH60.	Blu-ray 16	Blu-ray 16, from dark to bright.
CH61.	Reduce	Value 100-110 reset

18-channel mode

NO.	Function	Explain
CH1.	.Y axis	Y axis rotates
CH2.	Y-axis speed	Speed from fast to slow
CH3.	Total dimming	R, G, B,W.Total dimming, from dark to bright
CH4.	Total strobe	R, G, B,W.Total strobe, from slow to fast
CH5.	White dimming	WhiteDimming, from dark to bright.
CH6.	The white light walks by itself	0-19 dimming 21-40 Effect 1 ... 240-255 Effect 12
CH7.	White light speed	White light self-propelled speed,,From slow to fast
CH8.	Self-propelled direction	White light self-propelled direction: 1-128 forward; 129-255 reverse
CH9.	Red light	RedColorDimming, from dark to bright.
CH10.	Green dimming	GreenColorDimming, from dark to bright.
CH11.	Blue dimming	BlueColorDimming, from dark to bright.
CH12.	RGB self-propelled	0-9 dimming 10-15 Effect 1 ... 250-255 Effect 50
.CH13.	Velocity	RGB self-propelled speed,,From slow to fast
CH14.	Self-propelled direction	RGB self-propelled direction: 1-128 forward; 129-255 reverse
CH15.	Red light backlight	RedColorBackLight, from dark to bright.
CH16.	Green light backlight	GreenColorBackLight, from dark to bright.
CH17.	Blu-ray backlight	BlueColorBackLight, from dark to bright.
CH18.	Reduce	Value 100-110 reset

4 MENU OPERATIONS

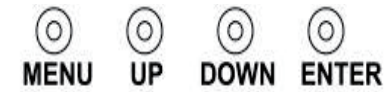

MENU:Menu key

UP:Add keys

DOWN:Subtraction key

ENTER:Confirmation key

2. Key description

MENUMenu key:Push downThe menu key can return to the previous interface..

UP.Add keys:Press this key to achieve it.Numerical valuePut one thing on top of anotherAnd function selection, long pressGo on uninterruptedlyTrigger.

DOWN.SubtractKey:Press this key to achieve it..Numerical subtraction and function selection, long pressGo on uninterruptedlyTrigger.

ENTERConfirmation key:Press the key to save the currently set parameter function,Enter the function page.

Two. Main Interface - Function Introduction

NO.	Content	FunctionCatch upExplain
1	EN	Chinese and English - Switch
2	14 CH	Channel display
3	Zero	Screen reverse switching
4	Manual	Self-propelled menu mode (Table 2.1)
5	Set up	512 Parameter Settings (Table 2.2)
6	System	Background Settings (Table 2.3-2.4)

.Screen saver: Long press the menu key to enter the unlock interface: enter 111 to unlock

System password: enter 222 to unlock, MENU key to switch digits, UP, DOWN key to switch symbols

Surface2.1 Manual mode

NO.	Content	Numerical range	FunctionCatch upExplain
1	Red	000-255	RedColorDimming, from dark to bright.
2	Green	000-255	GreenColorDimming, from dark to bright.
3	Blue	000-255	BlueColorDimming, from dark to bright.
4	White	000-255	WhiteDimming, from dark to bright.
5	Motor position	000-255	Y axis rotates
6	Result	.01 to 50	Functional effect
7	Velocity	01 -99	Effect speed adjustment
8	Flashing	01 -99	Flashing, the speed from slow to fast.

5 DMX CHANNELS

Surface 2.2TwoSet up

NO.	Content	Numerical range	FunctionCatch upExplain
1	Address	000-512	RedColorDimming, from dark to bright.
2	Passageway	8CH/14CH/ 18CH/61CH	Channel selection
3	Operating mode	DMX / AUTO	DMX dimming mode; self-propelled mode
4	Dimming	01-03	
5	Screen saver	ON/OFF	Screen backlight switch
6	Temperature protection	45-80	Temperature control protection
7	Power protection	50 to 250	Power protection
8	Fan speed control	40-70	Fan speed control
9	System reset	ON/OFF	System reset

Surface 2.3 System

NO.	Content	Numerical range	FunctionCatch upExplain
1	Lighting setting	000-512	Adjust the light
2	Motor travel	0000-2000	Motor total stroke setting
3	Motor calibration	000-255	Motor correction value
4	Running time	ON/OFF	512 signal maintenance settings
5	Edition	1700	Version and model

Surface 2.4 Lighting Settings

NO.	Content	Numerical range	FunctionCatch upExplain
1	Red light adjustment	000-255	RedColorDimming, from dark to bright.
2	Green light adjustment	000-255	GreenColorDimming, from dark to bright.
3	Blue light adjustment	000-255	BlueColorDimming, from dark to bright.
4	White light adjustment	000-255	WhiteDimming, from dark to bright.

8-channel mode

NO.	Function	Explain
CH1.	.Y axis	Y axis rotates
CH2.	Total dimming	R, G, B,W.Total dimming, from dark to bright
CH3.	Total strobe	R, G, B,W.Total strobe, from slow to fast
CH4.	White dimming	WhiteDimming, from dark to bright.
CH5.	Red light	RedColorDimming, from dark to bright.
CH6.	Green dimming	Green dimming, from dark to two.
CH7.	Blue adjustment	BlueColorDimming, from dark to bright.
CH8.	Reduce	Value 100-110 reset

.14-channel mode

NO.	Function	Explain
CH1.	.Y axis	Y axis rotates
CH2.	Y-axis fine-tuning	Y-axis fine-tuning
CH3.	White dimming	WhiteDimming, from dark to bright.
CH4.	White strobe	White strobe, from slow to fast
CH5.		Reserve
CH6.	The white light walks by itself	
CH7.	Red light	RedColorDimming, from dark to bright.
CH8.	Green dimming	Green dimming, from dark to two.
CH9.	Blue adjustment	BlueColorDimming, from dark to bright.
CH10.	RGB strobe	.From slow to fast
CH11.	Macro function	
CH12.	Macro function color	
.CH13.	Macro function speed	
CH14.	RGB backlight total dimming	