

**AVA MOXLITE**

# AMOS



## User Manual

KEEP THIS MANUAL FOR FUTURE NEEDS

[www.moxlite.com](http://www.moxlite.com)

# 1. SAFETY INSTRUCTIONS



## CAUTION

Becareful with your operations. With a dangerous voltage you can suffer a dangerous electric shock when touching wires!

- This device has left the factory in perfect condition. In order to maintain this condition and to ensure a safe operation, it is absolutely necessary for the user to follow the safety instructions and warning notes written in this user manual.



## IMPORTANT

Damages caused by the disregard of this user manual are not subject to warranty. The dealer will not accept liability for any resulting defects or problems.

- If the device has been exposed to temperature changes due to environmental changes, do not switch it on immediately. The arising condensation could damage the device.
- Leave the device switched off until it has reached room temperature.
- This device falls under protection-class I. Therefore it is essential that the device be earthed.
- The electric connection must carry out by qualified person.
- The device shall only be used with rate voltage and frequency.
- Make sure that the available voltage is not higher than stated at the end of this manual.
- Make sure the power cord is never crimped or damaged by sharp edges. If this would be the case, replacement of the cable must be done by an authorized dealer.
- Always disconnect from the mains, when the device is not in use or before cleaning it.
- Only handle the power cord by the plug. Never pull out the plug by tugging the power cord.
- During initial start-up some smoke or smell may arise. This is a normal process and does not necessarily mean that the device is defective, it should decrease gradually.
- Please don't project the beam onto combustible substances.
- Fixtures cannot be installed on combustible substances, keep more than 50cm distance with wall for smooth air flow, so there should be no shelter for fans and ventilation for heat radiation.
- If the external flexible cable or cord of this luminaire is damaged, it shall be exclusively replaced by the manufacturer or his service agent or a similar qualified person in order to avoid a hazard.

## 2. UNPACKING

The AMOS is a stylish moving head beam in a very compact and lightweight housing. It delivers high light output and even coverage field. It features a OSRAM SIRIUS HRI 250W Lamp. The lamp equips with the reflector built-in, providing perfect lamp alignment. The moving head features ultra sharp beam effect with low consumption. The fixture is integrated with a full complement of professional characteristics including a static gobo wheel, color wheel, two prisms, 7-color effect wheel, frost filter, motorized linear focus, variable speed shutter/strobe, linear dimmer, color time and gobo time controllable, etc.

The fixture's exterior housing is beautifully balanced basing on a modern design philosophy with supremely harmonious interior structure for remarkable control. The sculpted body of the PROBEAM achieves more than just a striking look. The 2\*1/4 turn fastening omega clamps, available for vertical and horizontal plug-in, make installations fast and easy.

It's applicable for large scale live concerts, TV productions, road shows, clubs, etc.

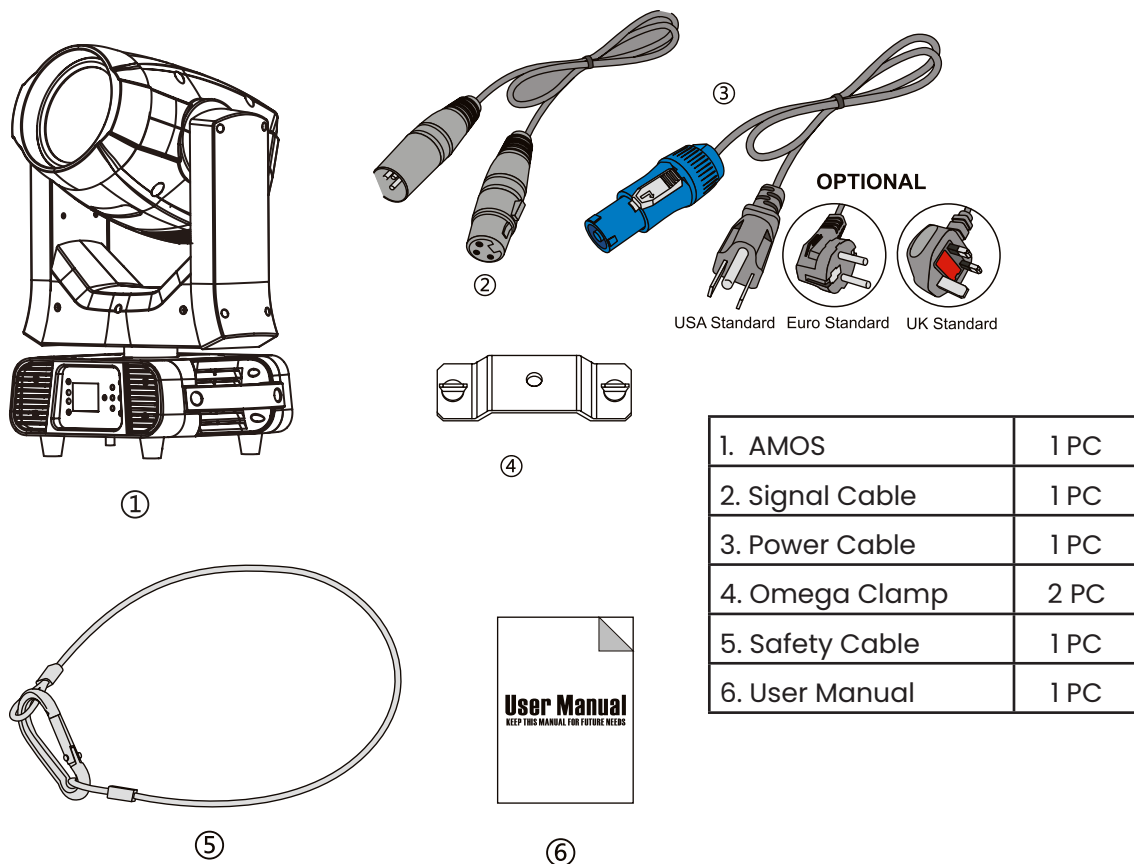

## 3. FEATURES & SPECIFICATIONS

- **Voltage** : AC100-240V 50/60Hz
- **Power** : 350W Power consumption
- **Source** : OSRAM SIRIUS HRI 250W Lamp
- **Life Span** : 1500H
- **Color Temperature** : 7800K
- **Dimensions** : 235(D)\*316.8(W)\*519(H)mm  
9,25\*12,47\*20,43"
- **Weight** : 12kg (26,45 lbs)
- **Movement** :
  - PAN movement: 540° (8/16 bit)
  - TILT movement: 270° (8/16 bit)
  - PAN & TILT Movement
- **Color** :
  - 1 Color wheel with 12 dichroic colors plus open
  - Variable direction rainbow effect with speed adjustable.
- **Control System** :
  - 16/22 DMX channels USITT DMX-512
  - DMX512, master-slave, sound activated or auto operation
  - Sound sensitivity adjustable
  - RDM available (Remote Device Management)
  - Shielded input signal protection for stable signal without interference
  - 3-Pin XLR connectors IN/OUT

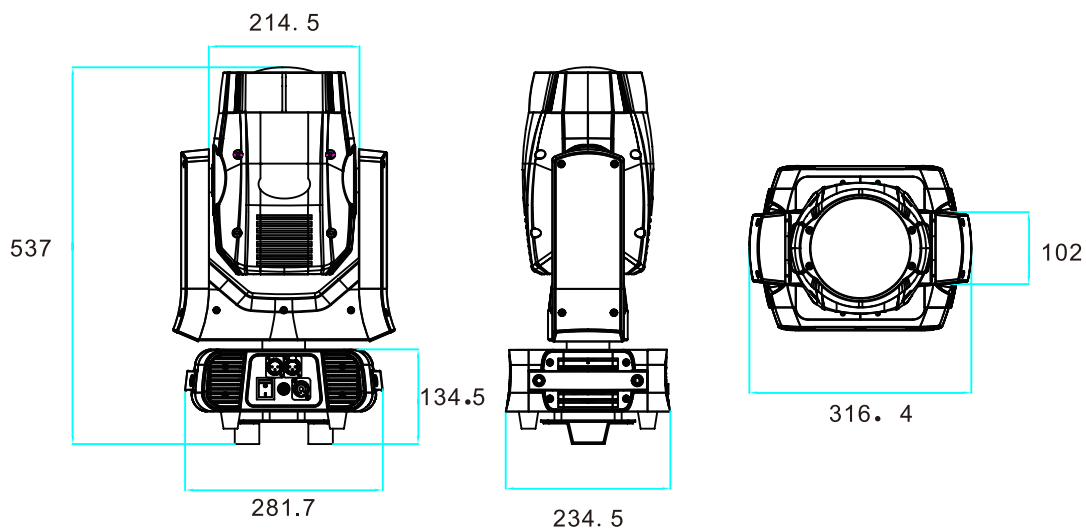

### Static gobos

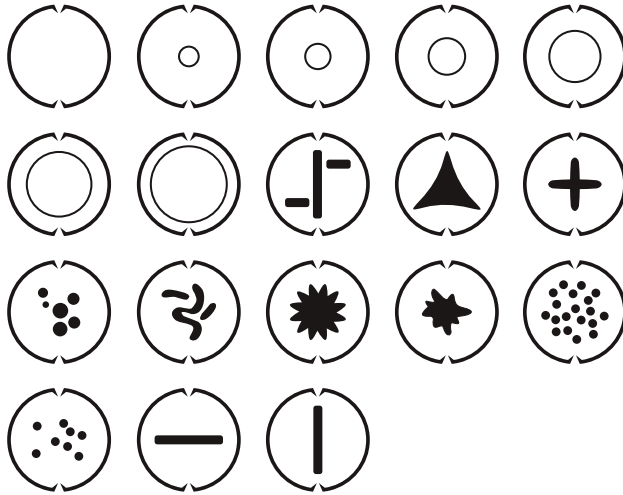

### Colors

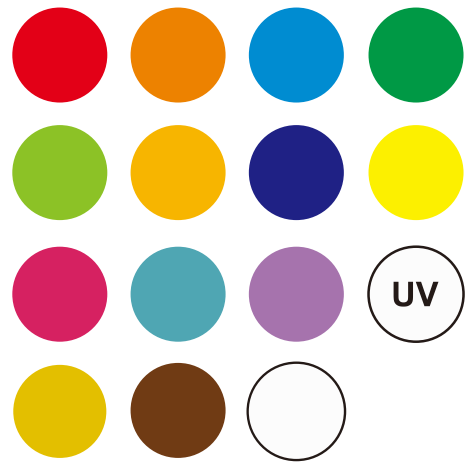

## 4. PHOTOMETRIC DATA

**Photometric Beam Angle Data**  $2^\circ \text{ Beam Angle}$   $\text{LUX} \times 0.0929 = \text{FC}$

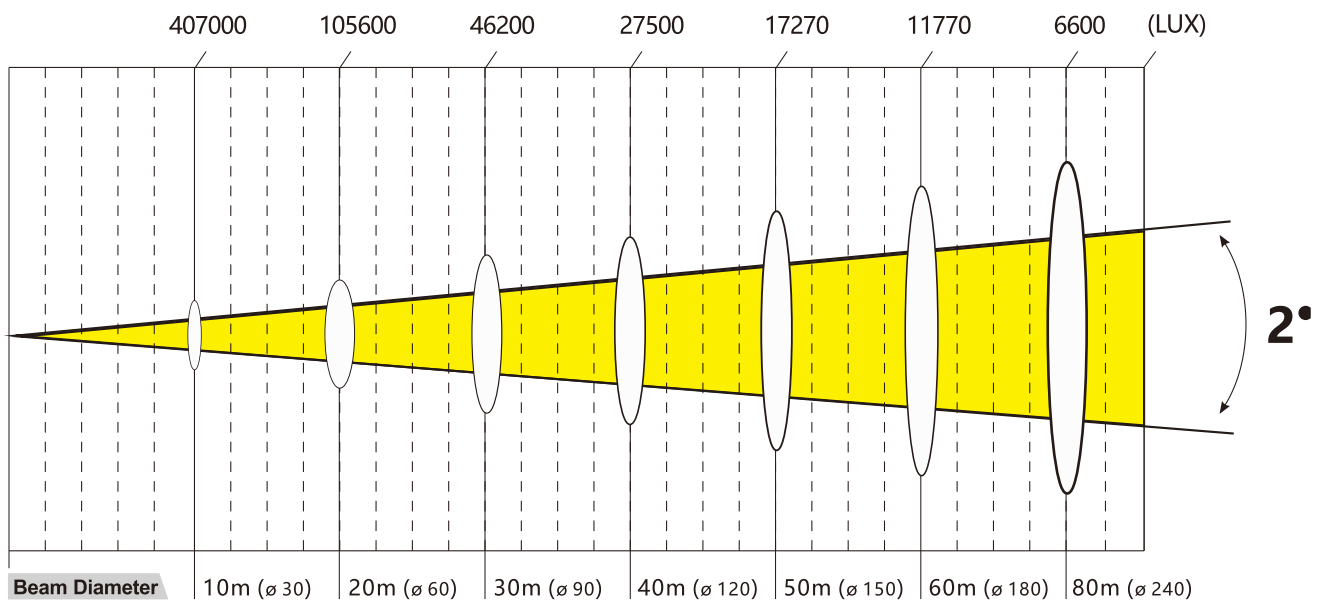

## 5. OPERATION INSTRUCTIONS

- The AMOS is for beam effect for on-site decoration purpose.
- Don't turn on the fixture if it's been through severe temperature difference like after transportation because it might damage the light due to the environment changes. So make sure to operate the fixture until it is in normal temperature.
- This light should be keep away from strong shaking during any transportation or movement.
- Don't pull up the light by only the head, or it might cause damages to the mechanical parts.
- Don't expose the fixture in overheat, moisture or environment with too much dust when installing it. And don't lay any power cables on the floor. Or it might cause electronic shock to the people.
- Make sure the installation place is in good safety condition before installing the fixture.
- Make sure to put the safety chain and check whether the screws are screwed properly when installing the fixture.
- Make sure the lens are in good condition. It's recommended to replace the units if there are any damages or severe scratch.
- Make sure the fixture is operated by qualified personnel who knows the fixture before using.
- Keep the original packages if any second shipment is needed.
- Don't try to change the fixtures without any instruction by the manufacturer or the appointed repairing agencies.
- It is not in warranty range if there are any malfunctions from not following the user manual to operate or any illegal operation, like shock short circuit, electronic shock, lamp broke, etc.

## 6. INSTALLATIONS

### Cautions:

- For added protection mount the fixtures in areas outside walking paths, seating areas, or in areas where the fixture might be reached by unauthorized personnel.
- Before mounting the fixture to any surface, make sure that the installation area can hold a minimum point load of 10 times the device's weight.
- Fixture installation must always be secured with a secondary safety attachment, such as an appropriate safety cable.
- Never stand directly below the device when mounting, removing, or servicing the fixture. From a ceiling, or set on a flat level surface (see illustration below).
- Be sure this fixture is kept at least 16m away from any flammable materials (decoration etc.).

*Always use and install the supplied safety cable as a safety measure to prevent accidental damage and/or injury in the event the clamp fails.*

### Mounting points:

- Overhead mounting requires extensive experience, including amongst others calculating working load limits, a fine knowledge of the installation material being used, and periodic safety inspection of all installation material and the fixture.
- If you lack these qualifications, do not attempt the installation yourself.
- Improper installation can result in bodily injury.
- Be sure to complete all rigging and installation procedures before connecting the main power cord to the appropriate wall outlet.

### Clamp Mounting:

- The AMOS provides a unique mounting bracket assembly that integrates the bottom of the base, and the safety cable rigging point in one unit (see the illustration below).
- When mounting this fixture to truss be sure to secure an appropriately rated clamp to the included omega bracket using a M10 screw fitted through the center hole of the "omega bracket".
- As an added safety measure be sure to attached at least one properly rated safety cable to the fixture using one of the safety cable rigging point integrated in the base assembly.

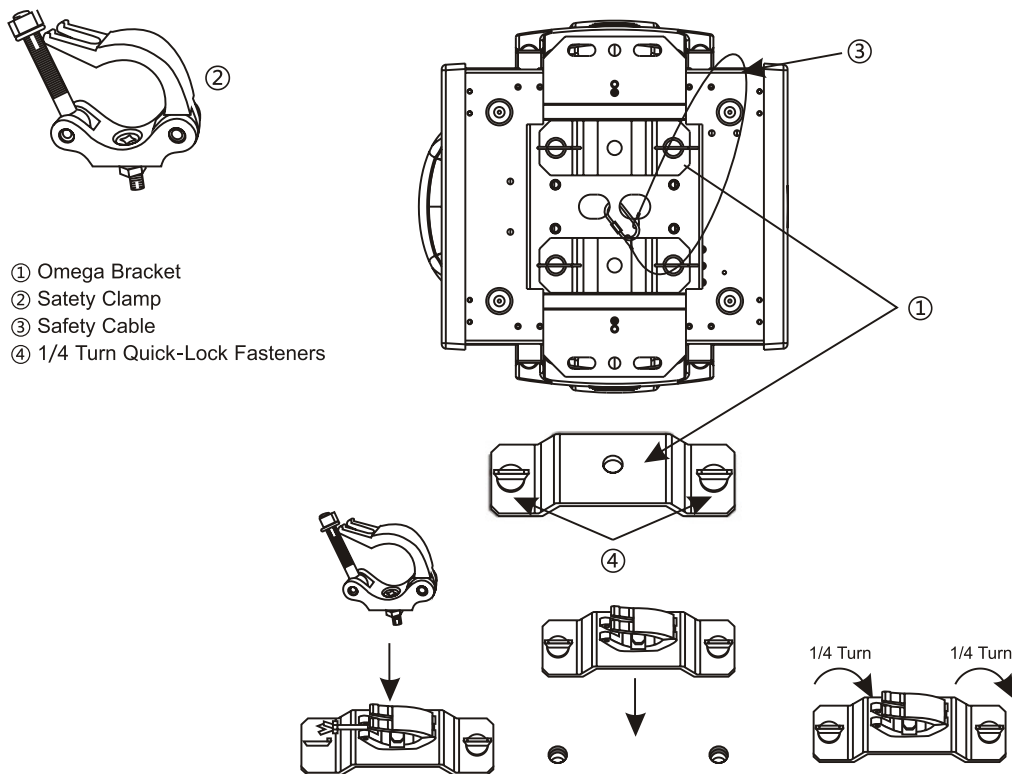

Regardless of the rigging option you choose for your AMOS, always be sure to secure your fixture with a safety cable. The fixture provides a built-in rigging point for a safety cable on the hanging bracket as illustrated above. Be sure to only use the designated rigging point for the safety cable and never secure a safety cable to a carrying handle.



## 7. DMX-512 CONTROL CONNECTIONS

Connect the provided XLR cable to the female 3-pin XLR output of your controller and the other side to the male 3-pin XLR input of the moving head. You can chain multiple Moving head together through serial linking. The cable needed should be two core, screened cable with XLR input and output connectors. Please refer to the diagram below.

DMX-512 connection with DMX terminator

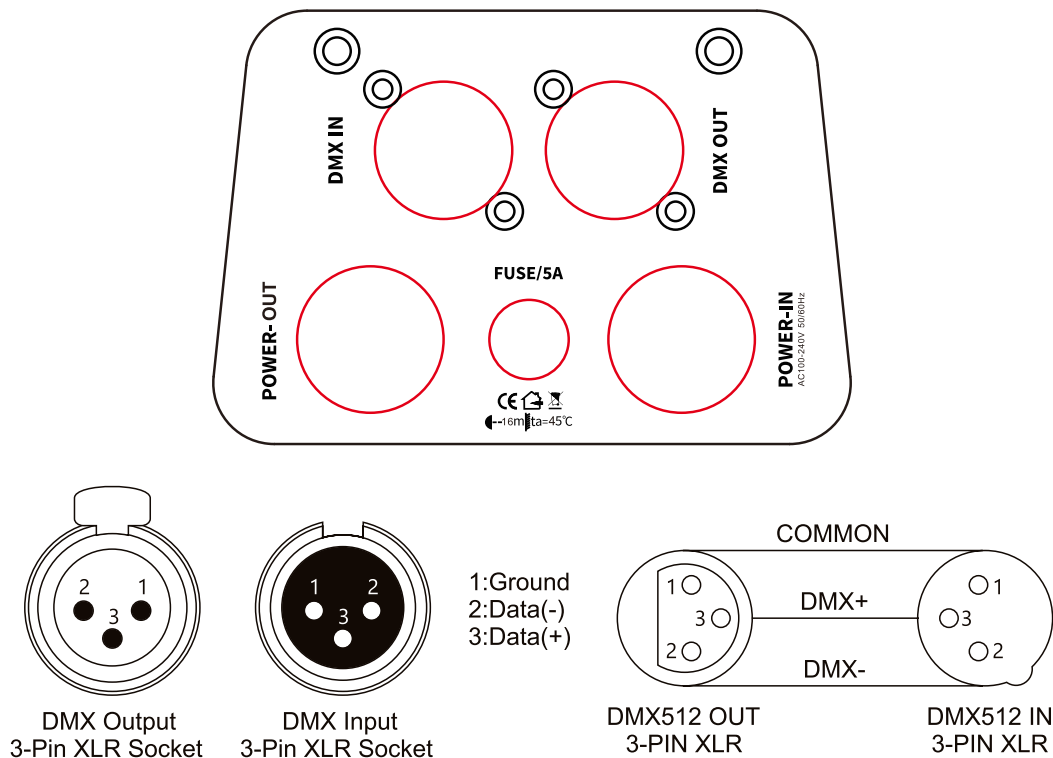

For installations where the DMX cable has to run a long distance or is in an electrically noisy environment, such as in a discotheque, it is recommended to use a DMX terminator. This helps in preventing corruption of the digital control signal by electrical noise. The DMX terminator is simply an XLR plug with a 120  $\Omega$  resistor connected between pins 2 and 3, which is then plugged into the output XLR socket of the last fixture in the chain. Please see illustrations below.

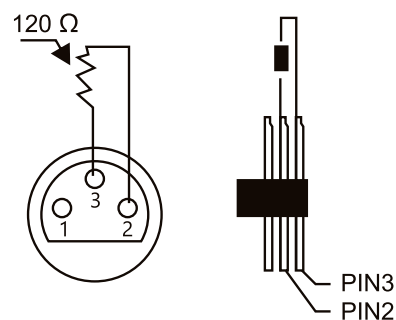

## 8. MENU OPERATIONS

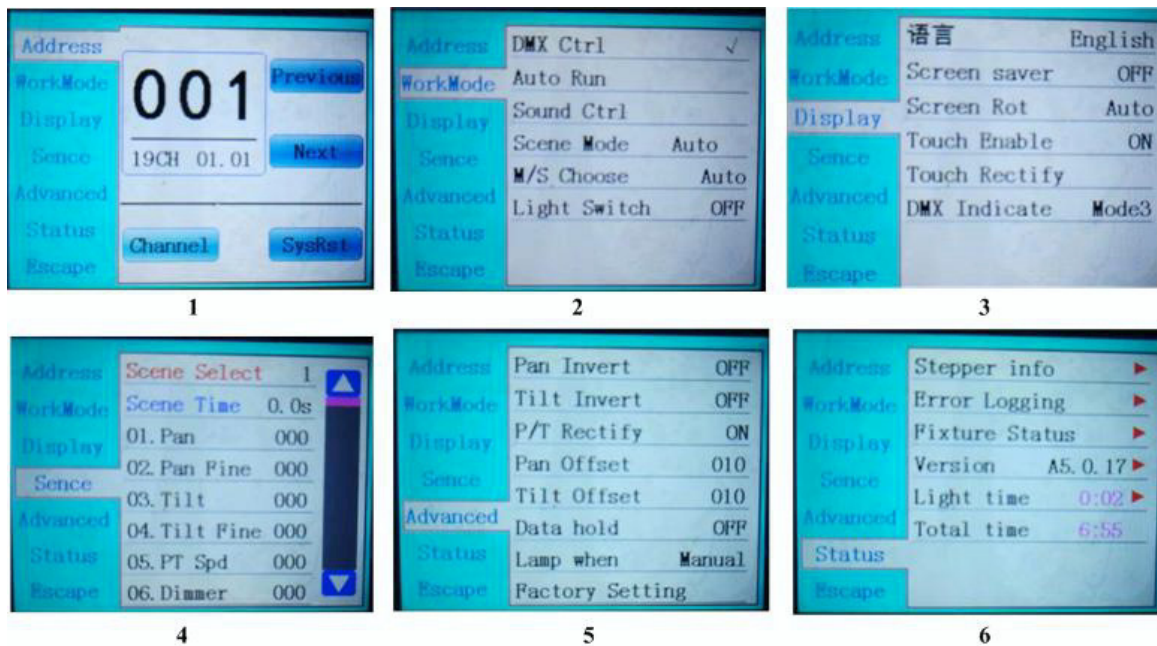

operating mode

DMXCtrl	DMX mode, receive DMX signal, RDM signal	
Auto Run	Fixture run automatically according to built-in programs	
Sound Ctrl	When the fixture detects a strong sound, the fixture automatically runs a scene according to the built-in program, otherwise it will stay the last scene	
Scene Mode01	runs in a set scene, which supports most of the custom editing of 10 scenes.	
	1~10	outputs the specified scene
	Auto	Automatically loops the output scene in the set scene time (non-zero) order, and the scene with time 0 automatically ignore
M/S Choose	Master and slave selection, non-DMX mode takes effect, select the mode of data output, fixture detect DMX cable state automatic switch output, prevent data conflicts	
	Master	fixture runs built-in program. If DMX has no signal, it outputs data (synchronization), otherwise it does not output data.
	Slave	fixture runs built-in program and does not output data
	Auto	If DMX has no signal, the fixture will run built-in program. Otherwise, the fixture will run in DMX Mode (follow DMX).
Lamp switch	(Lamp light source) pop-up confirmation dialog box, select "SURE" to confirm the current operation, turn on or off the lamp, switch time interval limited to 30 seconds	
	Off	the current lamp output is off
	On	The current lamp output is turned on

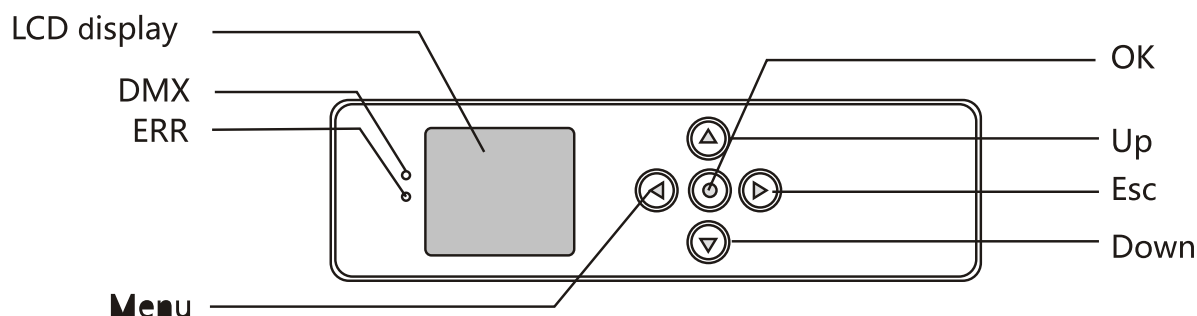

## DISPLAY SETTING

<b>Language</b>	display language settings	
	English	English display
	Chinese	Chinese display
<b>Screen saver</b>	Set screen 30 seconds without operation, the screen's display content or method.	
	OFF	Keep the last operation page
	Mode1	Black
	Mode2	Black screen, showing the address code of the current fixture in the lower left corner.
	Mode3	Display trademark information, address code and operation mode.
<b>Screen Rot</b>	Set the display direction of the screen.	
	OFF	No reverse display
	ON	Reverse display
	AUTO	Automatically detect the direction of lamps and automatically switch direction.
<b>DMX Indicate</b>	Set the indication mode of DMX signal indicator.	
	Mode1	When signal is bright, no signal is off.
	Mode2	When signal is off, no signal is bright.
	Mode3	When signal is flash, no signal is off.
<b>Signal Bright</b>	Set the brightness of the signal indicator	
	1~10	10
<b>Screen Lihgt</b>	Set the screen backlight for 10 seconds without operation	
	1~10	10
<b>Touch switch</b>	Choose whether to disable the touch function. When the screen touch is accidentally damaged, you can disable the touch function and use auxiliary input to set the fixture.	
Touch	When the screen touch function work anomaly, you can enter the corrected page corrections screen touch	

## SCENE MODE

Scene Select	Select the current operation scenario.	
	1~10	The 10 scenes sets the format
Scene Time	Sets the retention time of the current scene when it is automatic, unit in 0.1 seconds.	
	0	The current scene is not output in automatic scene output.
	1-255	0..1s-25.5s
1. PAN	0-255	Set up the data of each channel, and the contents and order of the display are one-to-one correspondence with the channel list of fixture.
.....	0-255	
.....	0-255	
N. Function	0-255	

## ADVANCED SETTING

Pan Invert	Set the rotation direction of PAN	
	OFF	
	ON	
Tilt Invert	Set the rotation direction of TILT	
	OFF	
	ON	
P/T Rectify	Setting up fixture to detect XY lost step and correct	
	OFF	Uncorrected position after out of step
	ON	After losing step, the position is automatically corrected and the out of step fault is recorded.
Pan Offset	Setting the zero point of the PAN of the fixture	
	4-150	
Tilt Offset	Setting the zero point of the TILT of the fixture	
	4-48	
Data hold	When the fixture is not equipped with DMX signal, the output state of the fixture	
	OFF	No signal, so the motor and light source return to the position and state when reset is completed.
	ON	No signal, keep the last frame DMX data output.
Lamp mode	Set the way to first open the lamp after power up	
	Power on	Turn on the lamp at power up and reset the lamp after 30 seconds.
	After reset	Reset the fixture after 3 seconds when power-on, and turn on the lamp after reset.
	Manual	After reset, manually turn on the lamp through the menu or console.
Factory Setting	Pop up the confirmation box, select "SURE", and return the lamp parameters to the factory settings.	

## 9. DMX CHANNELS

mode1	mode2	fuction	Values	description
CH1	CH1	Color	0-4	Open
			5-9	Open + Color1
			10-14	Color 1
			15-19	Color 1 + Color 2
			20-24	Color 2
			25-29	Color 2 + Color 3
			30-34	Color 3
			35-39	Color 3 + Color 4
			40-44	Color 4
			45-49	Color 4 + Color 5
			50-54	Color 5
			55-59	Color 5 + Color 6
			60-64	Color 6
			65-69	Color 6 + Color 7
			70-74	Color 7
			75-79	Color 7 + Color 8
			80-84	Color 8
			85-89	Color 8 + Color 9
			90-94	Color 9
			95-99	Color 9 + Color 10
			100-104	Color 10
			105-109	Color 10 + Color 11
			110-114	Color 11
			115-119	Color 11 + Color 12
			120-124	Color 12
			125-129	Color 12 + Color 13
			130-134	Color 13
			135-139	Color 13 + Color 14
			140-144	Color 14
			145-149	Color 14 + Open
			150-202	CW color rotation fast-slow
			203-255	CCW color rotation slow-fast

<b>CH2</b>	<b>CH2</b>	<b>Strobe</b>	0-3	Open
			4-103	Linear Strobe from Slow to Fast
			104-107	Open
			108-207	Pulse Strobe from Slow to Fast
			208-212	Open
			213-251	Random Strobe from Slow to Fast
			252-255	Open
<b>CH3</b>	<b>CH3</b>	<b>Dimmer</b>	0-255	0-100%Dimmer
<b>CH4</b>	<b>CH4</b>	<b>Gobos</b>	0-4	Open
			5-9	Gobo1
			10-14	Gobo 2
			15-19	Gobo 3
			20-24	Gobo 4
			25-29	Gobo 5
			30-34	Gobo 6
			35-39	Gobo 7
			40-44	Gobo 8
			45-49	Gobo 9
			50-54	Gobo 10
			55-59	Gobo 11
			60-64	Gobo 12
			65-69	Gobo 13
			70-74	Gobo 14
			75-79	Gobo 15
			80-84	Gobo 16
			85-89	Gobo 17
			90-128	CW gobo wheel rotation fast-slow
			129-131	Stop
			132-170	CCW gobo wheel rotation slow-fast
			171-175	Gobo 1 Shake slow-fast
			176-180	Gobo 2 Shake slow-fast
			181-185	Gobo 3 Shake slow-fast
			186-190	Gobo 4 Shake slow-fast
			191-195	Gobo 5 Shake slow-fast
			196-200	Gobo 6 Shake slow-fast
			201-205	Gobo 7 Shake slow-fast
			206-210	Gobo 8 Shake slow-fast
			211-215	Gobo 9 Shake slow-fast

			216-220	Gobo 10 Shake slow-fast
			221-225	Gobo 11 Shake slow-fast
			226-230	Gobo 12 Shake slow-fast
			231-235	Gobo 13 Shake slow-fast
			236-240	Gobo 14 Shake slow-fast
			241-245	Gobo 15 Shake slow-fast
			246-250	Gobo 16 Shake slow-fast
			251-255	Gobo 17 Shake slow-fast
<b>CH5</b>	<b>CH5</b>	<b>Prism1</b>	0-63	No Function
			64-255	Prism1
<b>CH6</b>	<b>CH6</b>	<b>Prism 1 Rotate</b>	0-127	Static Positioning 0-400
			128-187	CW Prism1 rotation fast-slow
			188-195	Stop
			196-255	CCW Prism1 rotation slow-fast
<b>CH7</b>	<b>CH7</b>	<b>Prism2</b>	0-63	No Function
			64-255	Prism2
<b>CH8</b>	<b>CH8</b>	<b>Prism 2 Rotate</b>	0-127	Static Positioning 0-400
			128-187	CW Prism2 rotation fast-slow
			188-195	Stop
			196-255	CCW Prism2 rotation slow-fast
<b>CH9</b>	<b>CH9</b>	<b>7-Colors</b>	0-63	No Function
			64-255	7-Color In
<b>CH10</b>	<b>CH10</b>	<b>Frost</b>	0-63	No Function
			64-255	Frost In
<b>CH11</b>	<b>CH11</b>	<b>Focus</b>	0-255	Near-Far
<b>CH12</b>	<b>CH12</b>	<b>Pan</b>	0-255	Pan Movement 0-540
	<b>CH13</b>	<b>Pan Fine</b>	0-255	Pan Movement 0-2
<b>CH13</b>	<b>CH14</b>	<b>Tilt</b>	0-255	Tilt Movement 0-270
	<b>CH15</b>	<b>Tilt Fine</b>	0-255	Tilt Movement 0-1
<b>CH14</b>	<b>CH16</b>	<b>Macro</b>	0-255	Macro1-16
<b>CH15</b>	<b>CH17</b>	<b>Reset</b>	26-76	Reset Effect
			77-127	Reset Pan Tilt
			128-255	Reset All
<b>CH16</b>	<b>CH18</b>	<b>Lamp</b>	26-100	Lamp Off
			101-255	Lamp ON
	<b>CH19</b>	<b>P/T Speed</b>	0-255	fast-slow
	<b>CH20</b>	<b>Color Speed</b>	0-255	fast-slow
	<b>CH21</b>	<b>Focus Speed</b>	0-255	fast-slow
	<b>CH22</b>	<b>GobosSpeed</b>	0-255	fast-slow

## 9. MAINTENANCE AND CLEANING

The following points have to be considered during the inspection:

1. All screws for installing the devices or parts of the device have to be tightly connected and must not be corroded.
2. There must not be any deformations on the housing, color lenses, fixations and installation spots (ceiling, suspension, trussing).
3. Mechanically moved parts must not show any traces of wearing and must not rotate with unbalances.
4. The electric power supply cables must not show any damage, material fatigue or sediments.

**Further instructions depending on the installation spot and usage have to be adhered by a skilled installer and any safety problems have to be removed.**



### CAUTION

Disconnect from mains before starting maintenance operation

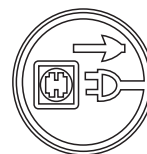

In order to make the lights in good condition and extend the life time, we suggest a regular cleaning to the lights.

1. Clean the inside and outside lens each week to avoid the weakness of the lights due to accumulation of dust.
2. Clean the fan each week.
3. A detailed electric check by approved electrical engineer each three month, makesure that the circuit contacts are in good condition, prevent the poor contact of circuit from overheating.

We recommend a frequent cleaning of the device. Please use a moist, lint- free cloth.

Never use alcohol or solvents.

There are no serviceable parts inside the device. Please refer to the instructions under "Installation instructions".

Should you need any spare parts, please order genuine parts from your local dealer.





#### Contact

---

@moxlite.prolight  
+62 859 2122 1107  
info@moxlite.com

#### HQ & Workshop

---

Global Multipro Technology  
Rukan Crown B no. 25  
Greenlake City, Cipondoh, Tangerang